

User manual of LedArt

System: Android, iPhone
Scan the QR code on the right to download;
Or search "LedArt"
in Google Play Store;
iPhone search "LedArt"
in the APP Store.



1. Wi-Fi connection

Turn off the mobile data /Bluetooth of the phone, turn on the WLAN in the phone setting, and connect to card's Wi-Fi

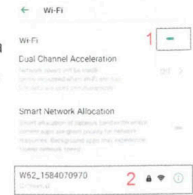

2. Check if the device is online

As shown right, click "Device", you can see the device information indicating that the device is online.



5. Hardware setting

Click "Device" → "Hardware setting", password is 888 → select the configuration file → "OK"

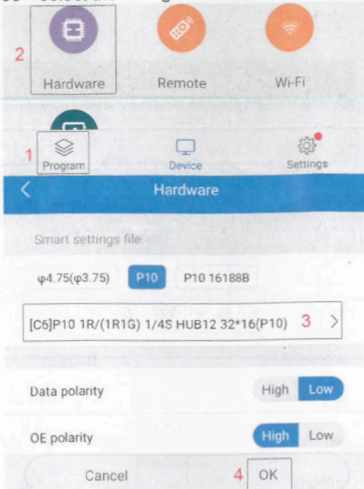

Note:

- 1) If black text on a red background, the data polarity is set in reverse;
- 2) If the text is dark, the OE polarity is set in reverse;

3. Create new screen (program)

Click the "program" → "new display" → select the device → "add" → set the width and height of screen → select the color → select the gray level → "OK"

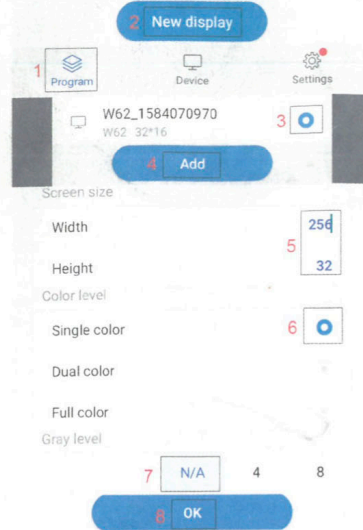

4. Edit and send the program

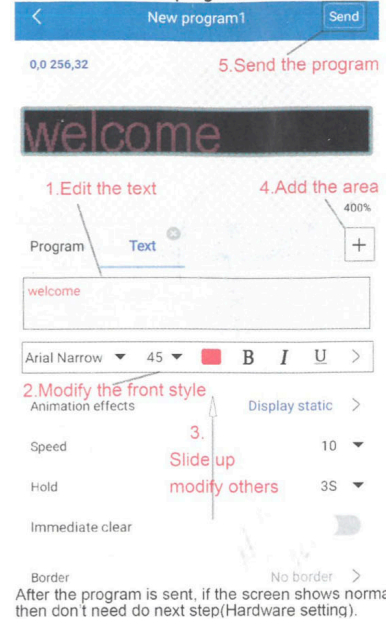

Q1. How to add multiple programs?

Exit program editing, return to the program list, add multiple programs, and edit the programs before sending them together.

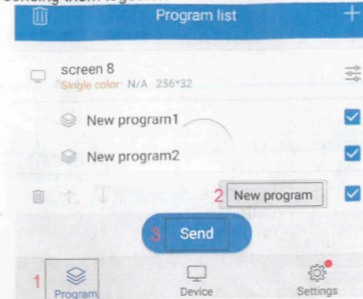

Q2. What should we do if forget the Wi-Fi password?

- 1) If the controller's firmware is V4.24 or above, when the controller is powered on, long press the button (S1) for 10 seconds, the password will be restored to the default 88888888;
- 2) If the firmware of the controller is below V4.24, need to reset the controller, the steps are as follows:
Step1. Power off the controller and find the button (S1);
Step2. Press and hold the button, and power on the controller (Do not lose the button);
Step3. After power on for 10 seconds, release the button. The password will be restored to the default 88888888, but the screen parameters may also be modified.

Q3. Quick checklist of Configuration file of module

Module Type	The back of the module	Configuration file
P10 Single color	P10 - SMD - 4S - V2.0	C6 Data-H, OE-H
P4.75 Single color	P4.75-6432-212-16S-1R-5166-V3	C2 Data-H, OE-L
P10 Single color	P10(1R) - 806L - M5.2 (CN4853)	C6 Data-H, OE-H
P10 Single color	HJCLPCB - P10R - 4S - C5	C6 Data-H, OE-H
P10 Double color	P10_RG_SSPQ_YTQ_NORES_V2.95	C6 Data-H, OE-L
P10 Single color	KT - P10 - 1R - 4S - V3.32	C6 Data-H, OE-L
P10 Single color	P10C4V2(QL)	C66
P10 Single color	P10(1R) - V709(GKGD)	C6
P10 Single color	P10C4V2.2(QL)	C27
P10 Single color	P10(1R) - V908AC(HJCL)	C6
P10 Single color	P10C4V1.6	
P10 Single color	P10C4V17	C46
P10 Single color	P10C4V23(QL)	
P10 Single color	P10(1R) - 960	C6
P10 Single color	P10 - 32X16 - 4S - V8	C6
P10 Single color	P10C4D1.3(QL)	C6
P10 Double color	YLR - P10(RG)/SMD3535 - 4S - V6	C6 Data-H, OE-L
P10 Double color	P10 - (16x32)RG - 4S - 1 - V2.0	C54
P10 Double color	P10-3535 (RG)-4S-V1.0 (LLR)	C6 Data-H, OE-L
P10 Single color	HJCLPCB - P10R-3535 - 01A - 4S	C27 Data-H, OE-L
P10 Single color	P10 - 1R - 3535 - 4S - V1	C65
P10 Single color	GKGD - PH10-1R - 2727 - 4S - V2.1	
P10 Single color	P10 - 3216 - 3528(1R) - 4S - V1.3	C6 Data-H, OE-H

Data-H is the Data polarity is high and L is low;
OE-L is the OE polarity is low and H is high.
If the configuration file don't work, pls do smart setting.